



HP Device as a Service (DaaS)

HP Confidential and Proprietary Information. May be shared with HP partners and customers in part or in total, subject to NDA in place between the parties. HP disclaims any and all liability in connection with the information contained herein. To be used for informational purposes only.

HP DaaS Proactive Management and Microsoft Intune Tenant Configuration

Table of Contents

INTRODUCTION	2
TERMS AND DEFINITIONS	2
INSTALLATION PREREQUISITES	2
TASK GUIDELINES	3
STEP 1 – CONFIGURE LINKING OF THE HP DAAS PROACTIVE MANAGEMENT TENANT TO INTUNE	3
STEP 2 – GRANT HP’S REMOTE SERVICE EXPERT TEAM PERMISSIONS TO ADMINISTER INTUNE TENANT	5

Introduction

The following steps need to be completed to link the Intune tenant with the HP DaaS Proactive Management tenant and validate that all functionality is working properly. The customer will be provided with an Enterprise Mobility Management (EMM) role in the HP DaaS Proactive Management tenant to link it with their Intune tenant.

Terms and Definitions

Below is a list of acronyms used in this document:

Acronym	Description
HP DaaS Proactive Management	HP DaaS Proactive Management with TechPulse
Intune	Microsoft Mobile Device Management Tenant
EMM	Enterprise Mobility Management
Azure AD	Azure Active Directory Tenant

Installation Prerequisites

1. HP DaaS Proactive Management tenant must already be set up for your company.
2. Customer user who is configuring the linking must have set up an HP ID and be able to sign into the HP DaaS Proactive Management portal as a user with the EMM role.
3. Customer user who is configuring the linking must be able to sign into Azure AD as a Global Administrator.

Task Guidelines

Step 1 – Configure linking of the HP DaaS Proactive Management tenant to Intune

1. Sign into the HP DaaS Proactive Management portal.

After you sign in you should see a screen like the below.

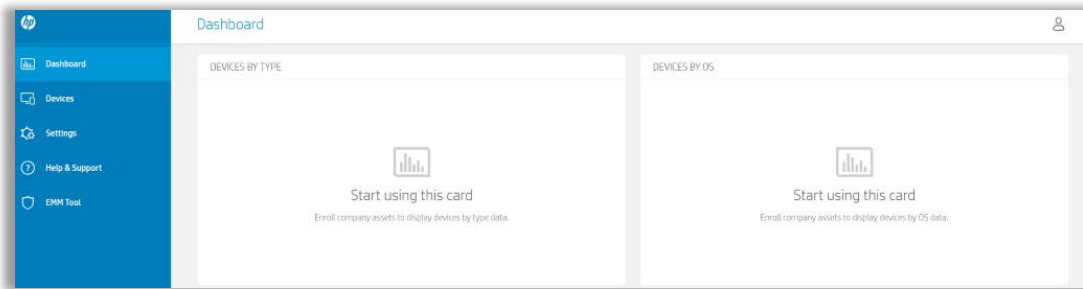

2. Click on **Settings**. If the Preferences tab is not already displayed, click on the **Preferences** tab.
3. Click on the **Edit** icon next to the REST API.

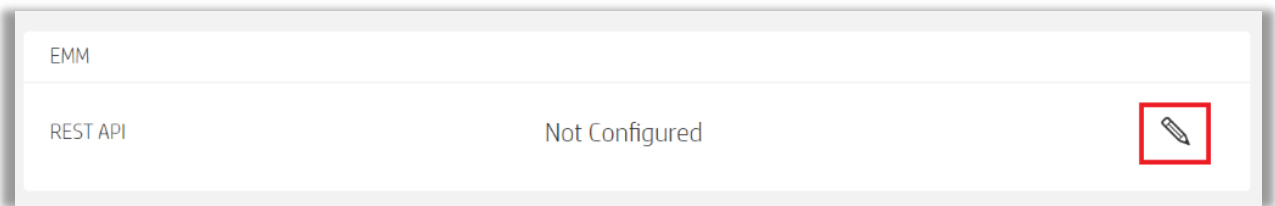

4. Select the **Intune** radio button and enter the following info.

Domain Name: This must match the primary Custom Domain name configured in the Azure AD tenant.

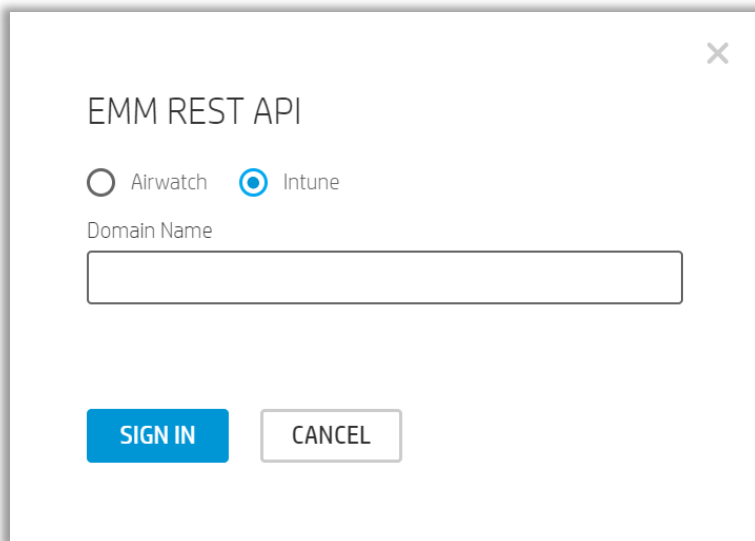
A screenshot of a dialog box titled 'EMM REST API'. The dialog box has a close button (X) in the top right corner. It contains two radio buttons: 'Airwatch' (unselected) and 'Intune' (selected). Below the radio buttons is a text input field labeled 'Domain Name'. At the bottom of the dialog box are two buttons: 'SIGN IN' (blue) and 'CANCEL' (white).

5. Click on **Sign In**.

6. Enter your Azure AD Global Administrator **credentials** to sign in.

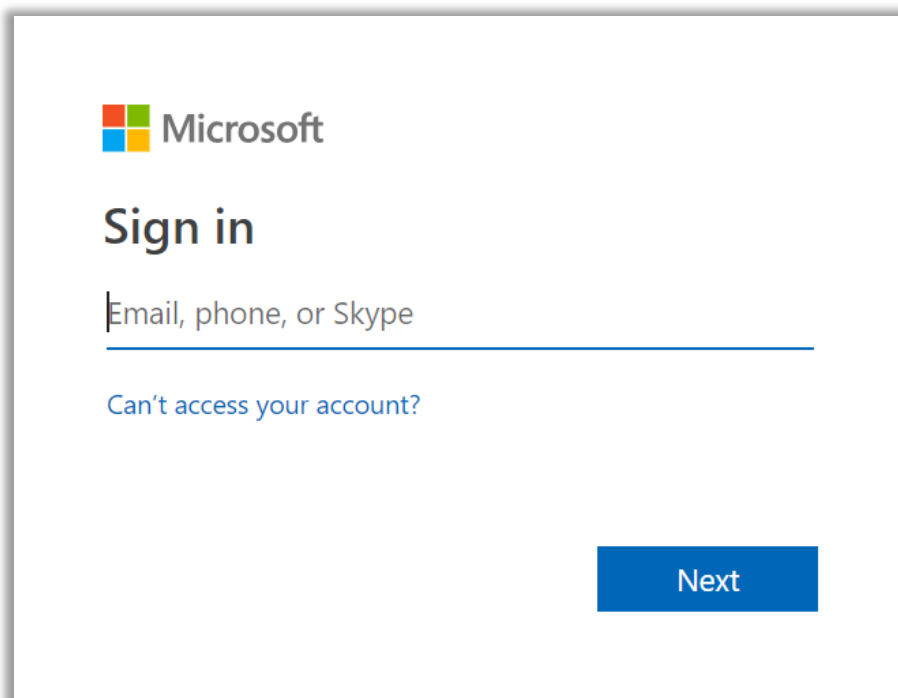

7. Prompt will appear to accept permissions to Read apps and devices in the Intune tenant. Click on **Accept**.

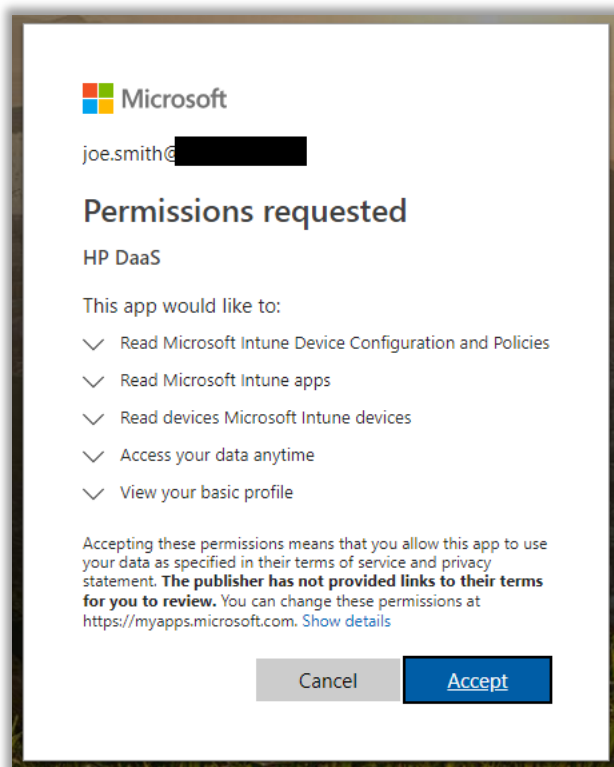

"Record updated successfully" green notification will show once linking is successful.



In the Azure AD tenant, under Enterprise Apps, the following Application entry will appear when the linking is completed.

NAME	HOMEPAGE URL	OBJECT ID
GE Graph explorer	https://developer.microsoft.com/en-us/graph/graph-explorer	9c9f01da-50fb-46a7-99df-cdb206156c09
HP DaaS		efaf760d-a2bc-450d-8d29-aa9bf677c2bd
MA Microsoft Azure Data Catalog		f3ba2d2d-c580-4692-b295-44ae21fd69ae

Step 2 – Grant HP’s Remote Service Expert Team permissions to administer Intune tenant

The HP Proactive Management onboarding team will provide you with a list of HP Remote Service Experts that will require Intune Administrator permissions to administer your Intune tenant. You will need to repeat the steps below for each of the Service Experts identified.

1. In your Azure AD tenant, navigate to **Users > All users**.
2. Click on the **New guest user** button.

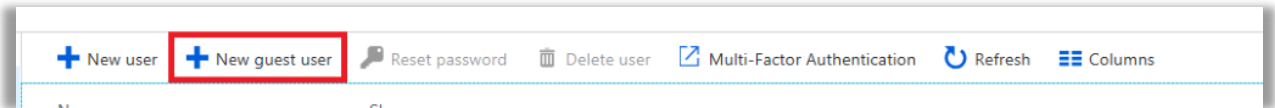

3. Enter the **email address** of the HP Remote Service Experts that will require access to your Intune tenant and click on **Invite**.

The screenshot shows the 'Add user' form in the Azure AD portal. At the top, there is a message: 'This user will be added as a Guest. Click here to learn more.' Below this, the 'Email address' field is required and contains the text 'jon.proactivemanagement@hp.com' with a green checkmark to its right. Below the email field is a text area labeled 'Include a personal message with the invitation'.

4. After the Guest User is added, select the Guest User and go to **Directory role**. Click on the **Add role** button.

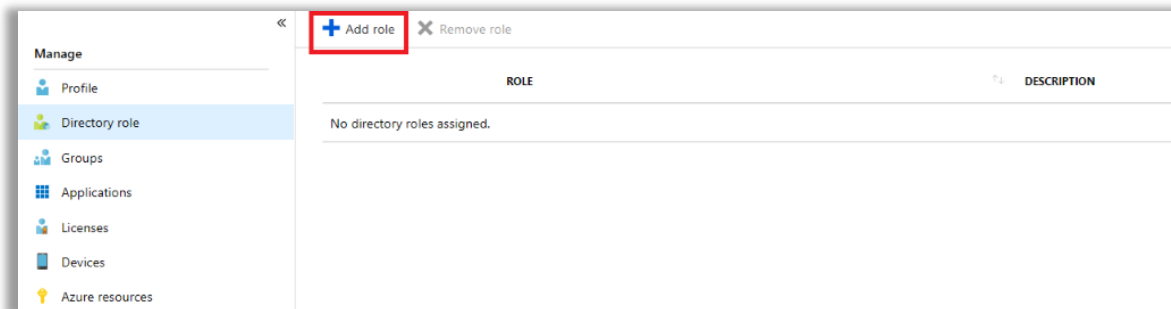

5. Grant the Intune Administrator role to the **Guest User**.

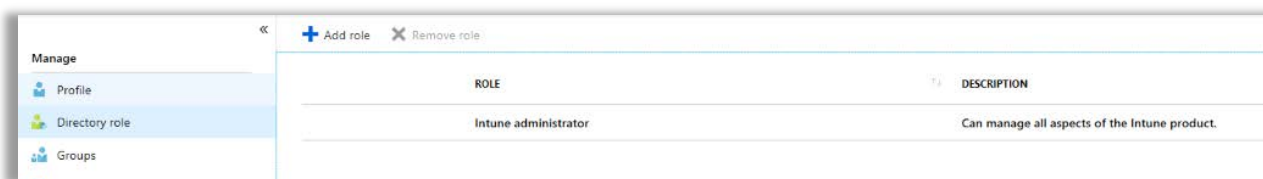

6. Inform your HP DaaS Proactive Management contact they now have permissions to administer the Intune tenant.

Document History

Last 4 Revisions				
Rev.	Amendment Detail	Reviewer	Approver	Date
0.1	Initial Release			Sept. 24, 2018

© Copyright 2018 HP Development Company, L.P. The information contained herein is subject to change without notice. The only warranties for HP products and services are set forth in the express warranty statements accompanying such products and services. Nothing herein should be construed as constituting an additional warranty. HP shall not be liable for technical or editorial errors or omissions contained herein.

Microsoft and Windows are either registered trademarks or trademarks of Microsoft Corporation in the United States and/or other countries.

4AA7-3782ENW – October 2, 2018