

CUSTOMIZE YOUR MFP WITH FLEXIBLE PART OPTIONS

Configurations & Options

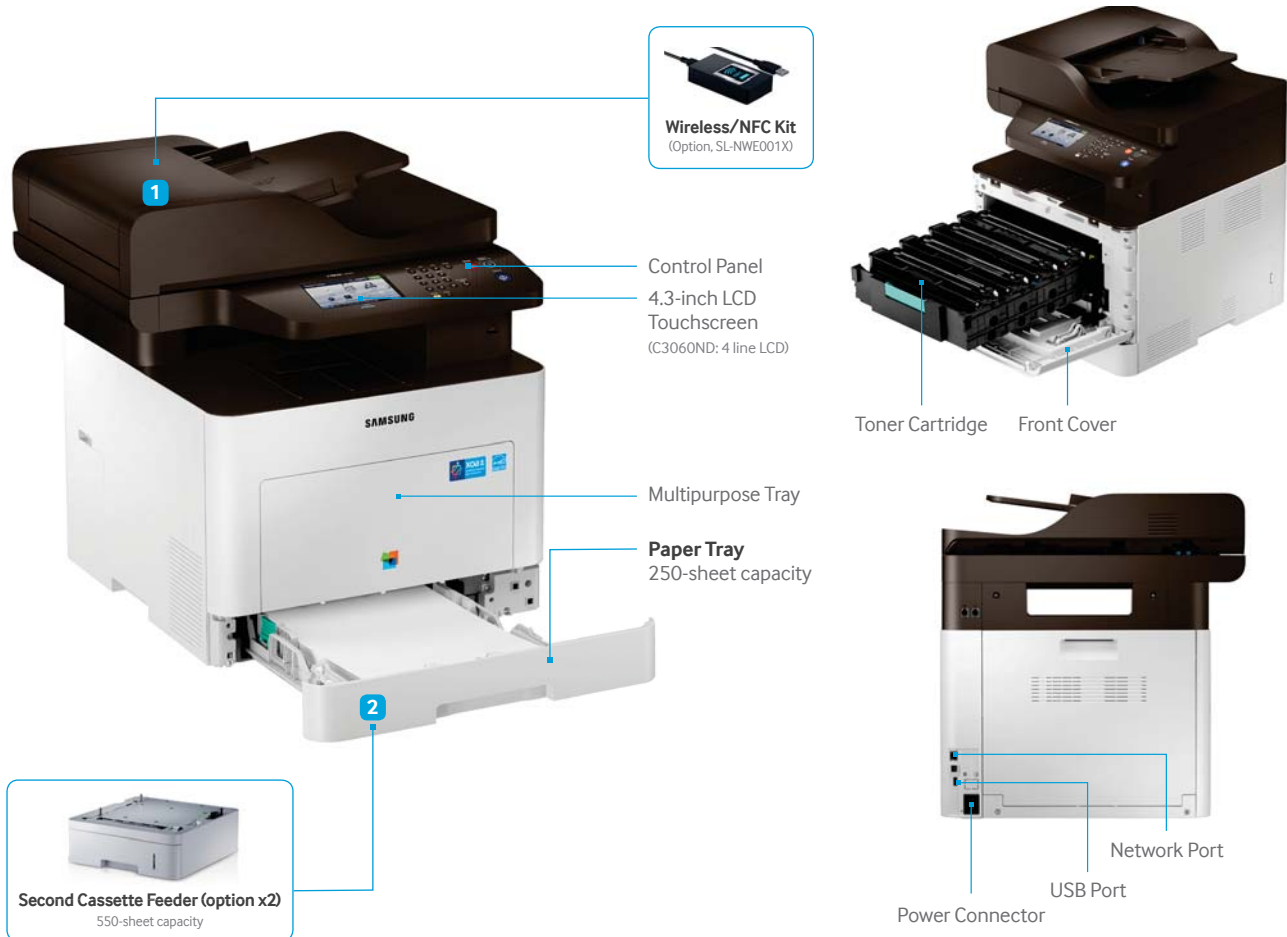

SAMSUNG

About Samsung Electronics Co., Ltd.

Samsung Electronics Co., Ltd. inspires the world and shapes the future with transformative ideas and technologies, redefining the worlds of TVs, smartphones, wearable devices, tablets, cameras, digital appliances, printers, medical equipment, network systems and semiconductors. We are also leading in the Internet of Things space through, among others, our Digital Health and Smart Home initiatives. We employ 307,000 people across 84 countries. To discover more, please visit our official website at www.samsung.com and our official blog at news.samsung.com/global.

Copyright © 2016 Samsung Electronics Co., Ltd. All rights reserved. Samsung and Samsung Cloud Print are either trademarks or registered trademarks of Samsung Electronics Co., Ltd. Specifications and designs are subject to change without notice. Nonmetric weights and measurements are approximate. All data were deemed correct at time of creation. Samsung is not liable for errors or omissions. All brand, product, service names and logos are trademarks and/or registered trademarks of their respective owners and are hereby recognized and acknowledged.

Samsung Electronics Co., Ltd.

129 Samsung-ro, Yeongtong-gu, Suwon-si, Gyeonggi-do 443-742, Korea

SAMSUNG

proXpress

Multifunction
C3060ND | C3060FR



Professional-quality
printing for you.
**Cost efficiency for
your business.**

SMART PRINTING.
BUSINESS INNOVATION.



INCREASE WORK PRODUCTIVITY WITH PROFESSIONAL PRINT QUALITY AND COST EFFICIENCY

Overview

Elevate your business with cost efficiency and professional printing

In today's competitive marketplace, businesses cannot afford devices that slow them down. Today's printers need to be cost-effective and ensure professional-grade print quality and high productivity for fast printing. A smart printing solution with exceptional performance and low maintenance cost is sought by every successful business.

Samsung's new ProXpress C3060 series provides businesses with the cost efficiency, professional print quality, and fast printing speed they need. The larger toner capacity reduces Total Cost of Ownership, and Samsung's IFS technology reduces power consumption. Businesses can also count on high-quality print and copy output with the finest details thanks to Samsung's ReCP technology. Samsung's ProXpress C3060 series ensures better productivity by cutting print times with exceptionally fast print speeds, and even allows businesses to expand their work range with support for a variety of thicker paper types. The C3060 series gives small and medium-sized enterprises the tools they need to compete at a higher level.

Samsung ProXpress :



Key benefits

Worry less about costs with money-saving technology

- Lower Total Cost of Ownership with larger toner capacity
- Reduce power consumption with Samsung's IFS technology

Print with professional-quality color and remarkable precision

- Enhanced graphic quality with Samsung's ReCP technology
- High-quality print and copy output with crisp details

Boost productivity with exceptionally fast printing

- Strong performance with Dual CPU (800MHz & 400MHz)
- Supports various types of thicker paper
- Supports XOA-Web for easy integration (C3060FR only)
- Equipped with PrinterOn

WORRY LESS ABOUT COSTS WITH MONEY-SAVING TECHNOLOGY



Lower Total Cost of Ownership with larger toner capacity

The high capacity toner cartridges yield 8K in mono and 5K in color, supporting businesses that have heavy print demand and cutting cartridge costs. Long-lasting consumable parts reduce maintenance costs significantly.



Reduce power consumption with Samsung's IFS technology

Energy-efficient Instant Fusing System (IFS) technology shortens warm-up periods before print jobs. It minimizes Total Energy Consumption when the device is sleeping, warming up, and operating.



PRINT WITH PROFESSIONAL-QUALITY COLOR AND REMARKABLE PRECISION

Enhanced graphic quality with Samsung's ReCP technology

Paying attention to details is critical for professionals. Samsung's ReCP technology built into the Samsung ProXpress C3060 series ensures crisp details, making sure even the smallest printed text is legible. It also gives you clean text and image scans, reducing blurry patterns.



High-quality print and copy output with crisp details

Images require accurate color expression and precise details. With the Samsung ProXpress C3060 series, you can print images with the natural colors of the original image, including all the small details with a wider contrast range, and even complex blue prints with intricate details.

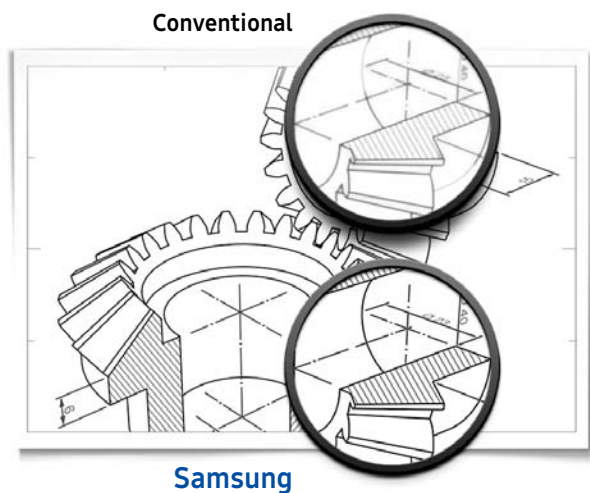
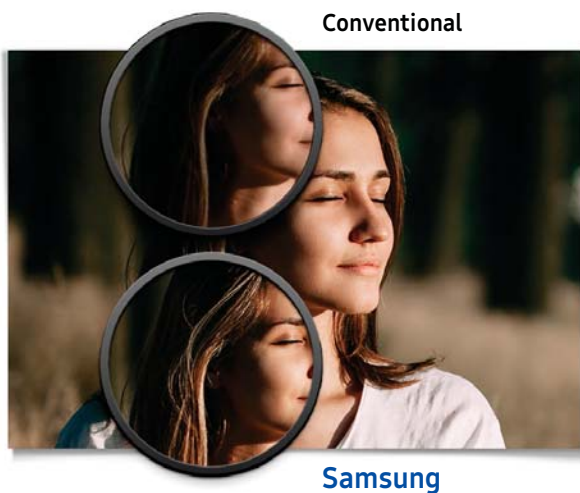

BOOST PRODUCTIVITY WITH EXCEPTIONALLY FAST PRINTING

Strong performance with Dual CPU

The Samsung ProXpress C3060 series is equipped with a Dual CPU optimized for printing. It boosts work productivity with remarkable print speed for heavy jobs, particularly when printing graphic images.

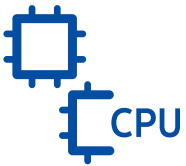

Dual CPU
Up to 30 ppm



Supports various types of thicker paper



Expand your range of productivity with the Samsung ProXpress C3060 series. With support for various types of thick paper up to 220g/m², you can print documents from office envelopes to professional certificates.



Supports XOA-Web for easy integration*

Get connected to printing solutions with the XOA-Web. The fast and easy integration of solutions will help your business run more efficiently and smoothly.



*Supports SL-C3060FR only

Equipped with PrinterOn

Print securely and efficiently from anywhere. Samsung's ProXpress C3060 series printers are equipped with PrinterOn, so if your business is already using it, you can easily add another device.



SAMSUNG MULTIFUNCTION PRINTER

proXpress C3060ND | C3060FR

Specifications

| General | C3060ND | C3060FR |
|-------------------------|--|---|
| Standard Function | Print, Copy, Scan | Print, Copy, Scan, Fax |
| Value Added Function | One-touch Eco Mode, Direct USB | One-touch Eco Mode, Direct USB, XOA-Web |
| Processor | 800MHz + 400MHz Dual CPU | |
| Operational Panel | 4 line LCD | 4.3" Touch Screen LCD |
| Memory Standard | 512 MB | |
| Hard Disk Drive | Not Applicable | 4 GB SD Card |
| Interface Standard | High-Speed USB 2.0 / USB Host / Ethernet 10/100/1000 Base-TX | |
| Interface Optional | IEEE 802.11b/g/n + Active NFC | |
| Power Consumption | - Printing: 500 W - Ready: 40 W - Sleep Mode: 1.4 W - TEC: 1.6 kWh | |
| Noise Level | - Printing: Less than 52 dBA - Copying: Less than 54 dBA - Ready: Less than 37 dBA | |
| Dimensions | 420 x 452.5 x 476.8 mm (16.54" x 17.81" x 18.77") | 469 x 452.5 x 504.3 mm (18.46" x 17.81" x 19.85") |
| Weight | 24.62Kg (54.28 lb) | 26.32Kg (58.03 lb) |
| Max. Monthly Duty Cycle | 60,000 Pages | |

| Print | C3060ND | C3060FR |
|----------------------------|--|--|
| Speed Mono | Up to 30 ppm in A4 (31 ppm in Letter) | |
| Speed Color | Up to 30 ppm in A4 (31 ppm in Letter) | |
| First Print Out Time Mono | As fast as 9 sec (From Ready Mode) | |
| First Print Out Time Color | As fast as 10 sec (From Ready Mode) | |
| Resolution | Up to 9,600 x 600 dpi Effective Output (600 x 600 x 4 bit) | |
| Print Languages | PCL5Ce, PCL6, PS3, PDF V1.7, SPL-C (Samsung Printer Language Color) | |
| Duplex Print | Bulit-in | |
| Client OS Support | - Windows®: Windows 2012 / 10 / 7 / Vista® / XP / 2008R2 / 2008 / 2003 - Mac OS®: X 10.6 - 10.11 - Various Linux® - Unix® | |
| Direct Print Support | PDF, JPEG, TIFF, PRN, XPS | |
| Print Features | Automatic Double Sided Print, Direct Print, Booklet, N-UP, Overlay, Cover, Poster, Watermark, Skip Blank Pages | Automatic Double Sided Print, Direct Print, Secure Print, Proof Print, Store Print, Booklet, N-UP, Overlay, Cover, Poster, Watermark, Skip Blank Pages |

| Copy | C3060ND | C3060FR |
|----------------------------|---|---------|
| Speed Mono | Up to 30 cpm in A4 (31 cpm in Letter) | |
| Speed Color | Up to 30 cpm in A4 (31 cpm in Letter) | |
| First Print Out Time Mono | As fast as 13 sec (Platen) | |
| First Print Out Time Color | As fast as 13 sec (Platen) | |
| Resolution Optical | 600 x 600 dpi (Optical Upto 600 x 600 dpi depending on Original Type) / Printing: Up to 9600x600 dpi effective output (600 x 600 x 4 bit) | |
| Reduce / Enlarge Range | 25 - 400% (ADF/Platen) | |
| Multi Copy | 9,999 Pages | |
| Duplex Copy | Built-in | |
| Copy Feature | ID Copy, N-UP Copy, Book Copy, Watermark Copy, Collated Copy | |

| Scan | C3060ND | C3060FR |
|---------------------|---|---|
| Speed Mono | - Lineart/Hartone: Approx. 18 ipm (@ 300 dpi) - Gray: Approx. 18 ipm (@ 300 dpi) | - Lineart/Hartone: Approx. 24 ipm (@ 300 dpi) - Gray: Approx. 24 ipm (@ 300 dpi) |
| Speed Color | Approx. 18 ipm (@ 300 dpi) | |
| Compatibility | Twain Standard, WIA Standard | |
| Method | Color CIS | |
| Resolution Optical | Up to 1,200 x 1,200 dpi | |
| Resolution Enhanced | Up to 4,800 x 4,800 dpi | |
| Scan Destinations | USB, Email, SMB, FTP, PC, WSD, Samsung Cloud | Scan to Shared Folder, USB, Email, SMB, FTP, PC, WSD, Samsung Cloud |



| Fax | C3060ND | C3060FR |
|--------------------|----------------|--|
| Compatibility | Not Applicable | ITU-T G3 |
| Modem Speed | | 33.6 kbps |
| Resolution | | - Mono: Up to 300 x 300 dpi - Color: Up to 200 x 200 dpi |
| Compression Method | | MH, MR, MMR, JBIG, JPEG |
| Memory | | SD card |
| Auto Dial | | Yes |
| Fax Feature | | Multi-Send, Delayed Send, Secure Receive, Fax Forwarding |

| Paper Handling | C3060ND | C3060FR |
|----------------------------------|---|---------|
| Input Capacity Cassette | 250 Sheets | |
| Input Capacity Maximum | 1,400 Sheets (Std 250 + MP 50 + 2 x SCF 550) | |
| Input Capacity Multipurpose Tray | 50 Sheets | |
| Input Capacity Other Options | 550 Sheets | |
| Media Type Cassette | Plain Paper / Thin Paper / Thick Paper / Cardstock / Thicker Paper / Hole Punched / Pre-Printed / LetterHead / Recycled / Archive / Bond / Label / Envelope / Cotton / Colored / Glossy | |
| Media Type Multipurpose Tray | Plain Paper / Thin Paper / Thick Paper / Cardstock / Thicker Paper / Hole Punched / Pre-Printed / LetterHead / Recycled / Archive / Bond / Label / Envelope / Cotton / Colored / Glossy | |
| Media Type Other Options | Plain Paper / Thin Paper / Thick Paper / Cardstock / Hole Punched / LetterHead / Recycled / Archive / Bond | |
| Media Size Cassette | A4 / Letter / Legal / Oficio / Folio / JIS B5 / ISO B5 / Executive / A5 / Statement / A6 / Postcard / Envelope Monarch / Envelope No-10 / Envelope DL / Envelope C5 / Envelope C6 / Envelope No 9 / Custom [98 x 127 mm (3.86" x 5") - 216 x 356 mm (8.5" x 14")] | |
| Media Size Multipurpose Tray | A4 / Letter / Legal / Oficio / Folio / JIS B5 / ISO B5 / Executive / A5 / Statement / A6 / Index Card Stock / Postcard / Envelope Monarch / Envelope No-10 / Envelope DL / Envelope C5 / Envelope C6 / Envelope No 9 / Custom [76 x 127 mm (3" x 5") - 216 x 356 mm (8.5" x 14")] | |
| Media Size Other Options | A4 / Letter / Legal / Oficio / Folio / JIS B5 / ISO B5 / Executive / A5 / Statement / Custom [98 x 210 mm (3.86" x 8.3") - 216 x 356 mm (8.5" x 14")] | |
| Media Weights Cassette | Supported Weight: 60 - 220 g/m ² (16 - 59 lb), Thin Paper (60 - 69 g/m ²) / Plain Paper (70 - 90 g/m ²) / Thick Paper (91 - 105 g/m ²) / Bond Paper (105 - 120 g/m ²) / Cardstock (121 - 163 g/m ²) / Thicker Paper (164 - 220 g/m ²) | |
| Media Weights Multipurpose Tray | Supported Weight: 60 - 220 g/m ² (16 - 59 lb), Thin Paper (60 - 69 g/m ²) / Plain Paper (70 - 90 g/m ²) / Thick Paper (91 - 105 g/m ²) / Bond Paper (105 - 120 g/m ²) / Cardstock (121 - 163 g/m ²) / Thicker Paper: (164 - 220 g/m ²) | |
| Media Weights Other Options | Supported Weight: 60 - 163 g/m ² (16 - 43 lb), Thin Paper (60 - 69 g/m ²) / Plain Paper (70 - 90 g/m ²) / Thick Paper (91 - 105 g/m ²) / Bond Paper (105 - 120 g/m ²) / Cardstock: (121 - 163 g/m ²) | |
| Output Capacity | 150-Sheet Face Down | |
| ADF Type | ADF | RADF |
| ADF Document Capacity | 50 Sheets | |

| Options | C3060ND | C3060FR |
|---------|--------------------------------|---------|
| | 550 Sheets SCF, Wireless + NFC | |

| Consumable | C3060ND | C3060FR |
|-----------------------------|--|---------|
| Toner Capacity / Model Code | (K) High Toner Cartridge Yield: 8,000 Standard Pages (Ships with 4,000 Pages Starter Toner Cartridge) / CLT-K503L *Declared Yield Value in accordance with ISO/IEC 19798 (CMY) High Toner Cartridge Yield: 5,000 Standard Pages (Ships with 2,500 Pages Starter Toner Cartridge) / CLT-C503L, CLT-M503L, CLT-Y503L *Declared Yield Value in accordance with ISO/IEC 19798 | |
| Waste Toner Container | (K) Approx. 20,000 Pages / (CMY) Approx. 5,000 Pages | |

| Solution | C3060ND | C3060FR |
|-----------------------------------|----------------|---------|
| Device Management | Yes | Yes |
| Output Management | Not Applicable | Yes |
| Document Capture and Distribution | Not Applicable | Yes |
| Mobility | Yes | Yes |